

**A**

?

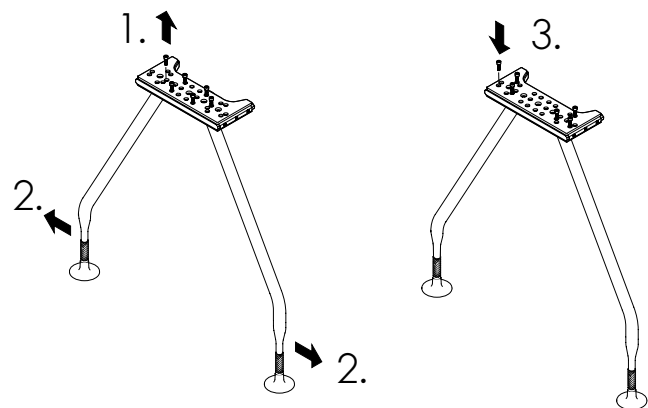
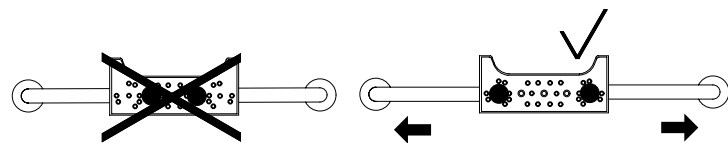
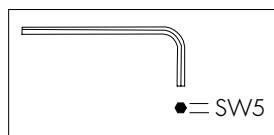
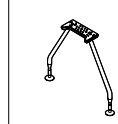

1-3x

**B**

?

68-78

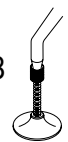

710 222 02



?

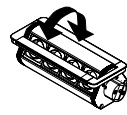

710 222 18

**C**

GB

Note the position and number of units. (D-H)

D

CH

Position und Stückzahl beachten. (D-H)

F

Respecter la position et le nombre. (D-H)



NL

Let op positie en aantal. (D-H)

E

Tener en cuenta la posición y el número de piezas. (D-H)

**D**

?

x



		12x
		14x
		16x

**E**

?

x

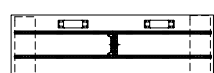
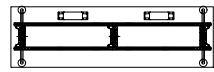
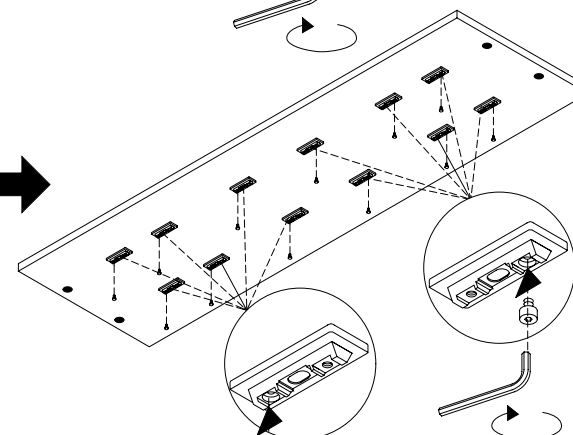
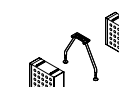
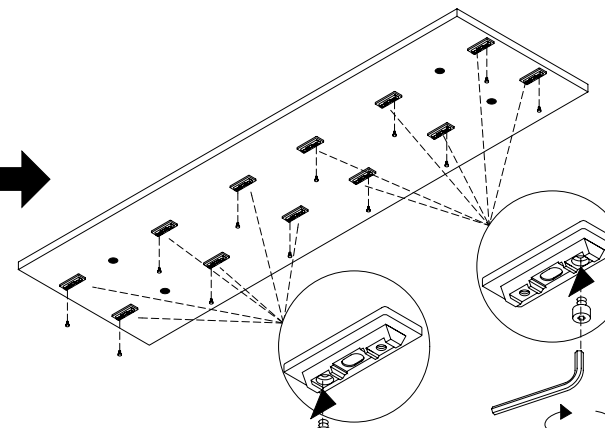
**F**

72

74

76

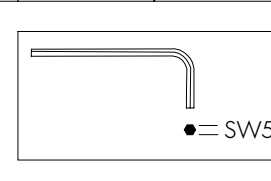
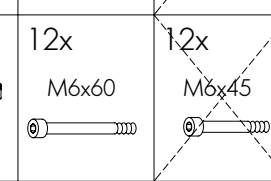
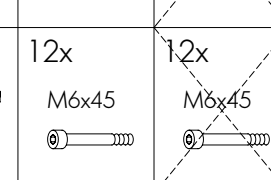
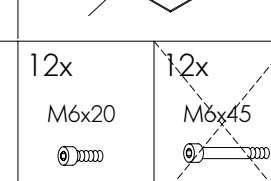
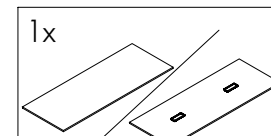

●= SW5

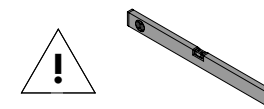
**G**

M6x45

3

32

34

3

32

34

3

3

32

34

3

32

34

3

32

34

3

32

34

3

32

34

3

32

34

3

32

34

3

32

34

3

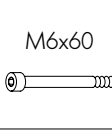
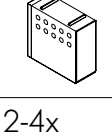
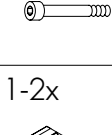
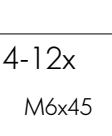
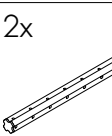

●= SW5

# Ad Hoc

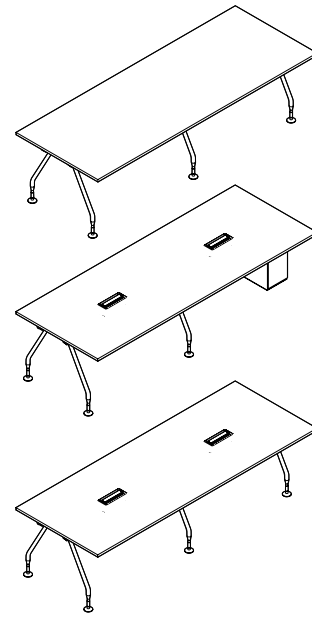

**H**

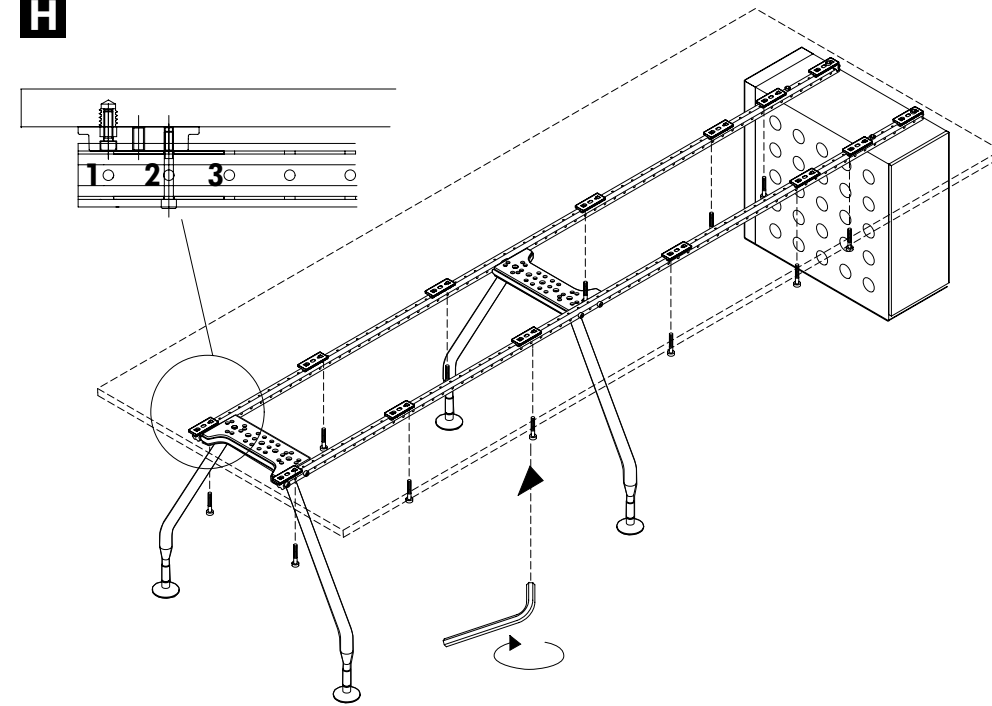

12x

M6x45

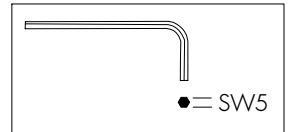
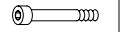

● = SW5